

Product data sheet

System Type 6 N30

System sketch:

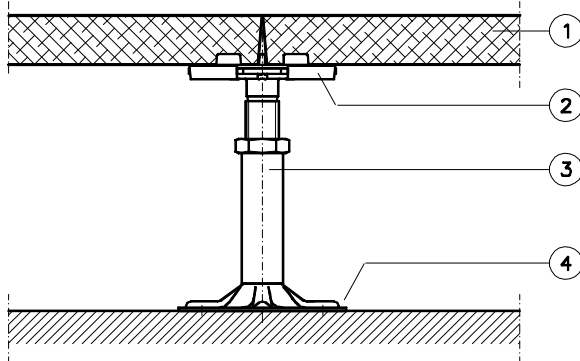

- 1 Access floor panel (optionally with or without floor covering, primered)
- 2 Gasket
- 3 Pedestal (type of construction depending on floor height)
- 4 Base plate glued to the subfloor, dowelled on request

Panel:

Dimensions: 600 x 600 mm (special dimensions possible)
 Panel thickness: 30 mm
 Panel surface: --
 Panel underside: aluminium coating on request
 System weight: approx. 49 kg/m² (no covering, floor height 250 mm)
 Panel weight: approx. 16,7 kg
 Panel material: fibre-reinforced calcium-sulphate

Understructure:

Pedestal distance: 600 mm
 Pedestal material: galvanized steel
 Construction height: 70-1800 mm
 Stringer: --
 Recommendation: use stringers from a floor height of > 500 mm, e.g. u-type stringer

Load values*:

Concentrated load: 2.000 N
 class 1
 Acc. to DIN EN 12825
 Nominal load and deviation: 2.000 N-A
 Ultimate load: > 4.000 N
 Certificate of conformity: --
 With pressure stamp of \varnothing 80 mm: 3.000 N
 Distributed load: 12.500 N / m²

Electrostratic: (DIN EN 1081 / DIN 54345)

Depending on floor covering: R_2 or $R_G > 10^6$ Ohm
 Without floor covering: R_2 or $R_G > 10^9$ Ohm (conductive system on request)

Fire protection:

Building material class (EN 13501-1): A1
 Building material class (B/Q acc. to ÖN B 3810/B3800): B1/Q1
 Fire resistance class (DIN 4102 T2): F30 (tested-fth 1000 mm)

Sound absorption: (DIN 52210; DIN EN ISO 140)

	Sound absorbing fascia	horizontal		vertical		Valued sound reduction $R_{w,P}$
		Sound reduction value $R_{L,w,P}$ in [dB]	Footfall sound $L_{n,w,P}$ in [dB]	Impact sound reduction $L_{w,P}$ in [dB]		
				No pads	With pads	
Text coverings	without	54	40	35	--	--
Surface	with	--	--			
Hard coverings	without	52	63	19	--	--
Surface	with	--	--			

* The loads are depending on the test conditions, especially on the test method and the size of stamp. MERO distinguishes between an elementary test acc. to the rules of use of DIN EN 12825 and a historically grown component test method with a stamp of \varnothing 80 mm. **MERO recommends the values acc. to the rules of use DIN EN 12825.**